

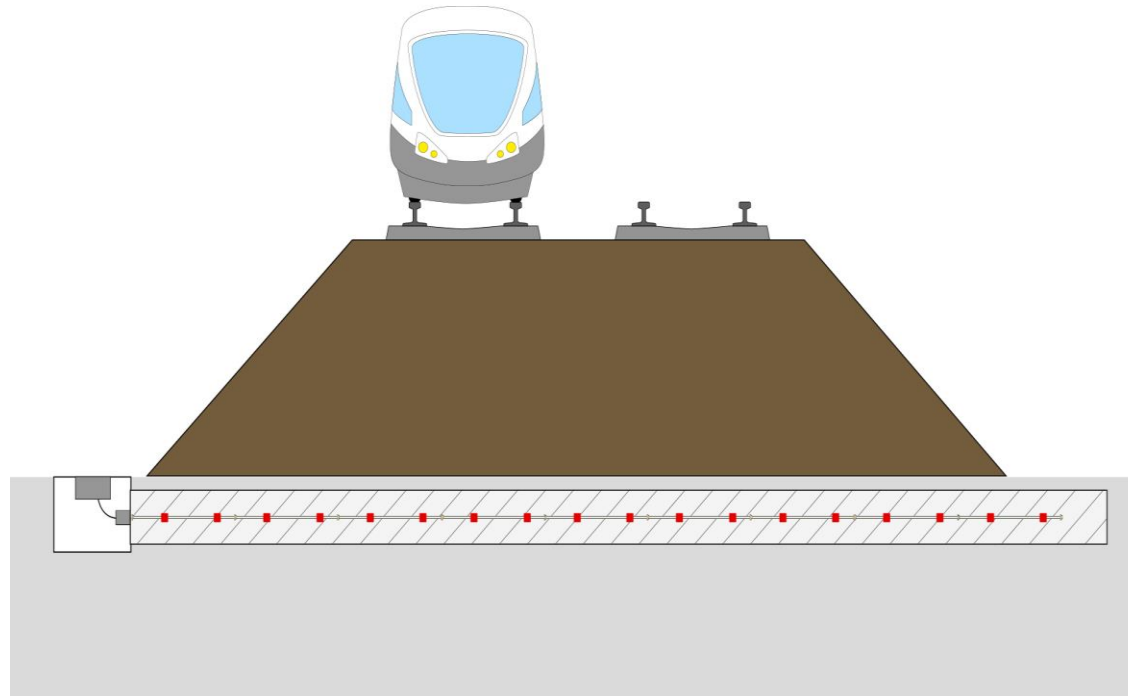

— LT-INCLIBUS
MAIN APPLICATIONS



__ APPLICATION SCHEME: EMBANKMENTS



Application:

- *In this application LT-Inclibus measures a chain of local tilting, helping to detect any possible local settlement.*
- *LT-Inclibus is not intended to read cumulative displacement.*

Installation:

- *Grouted in casings or layed in tranches and backfilled.*
- *Installation within pipes/casings without internal grouting is not allowed.*

__ APPLICATION SCHEME: UNSTABLE SLOPES

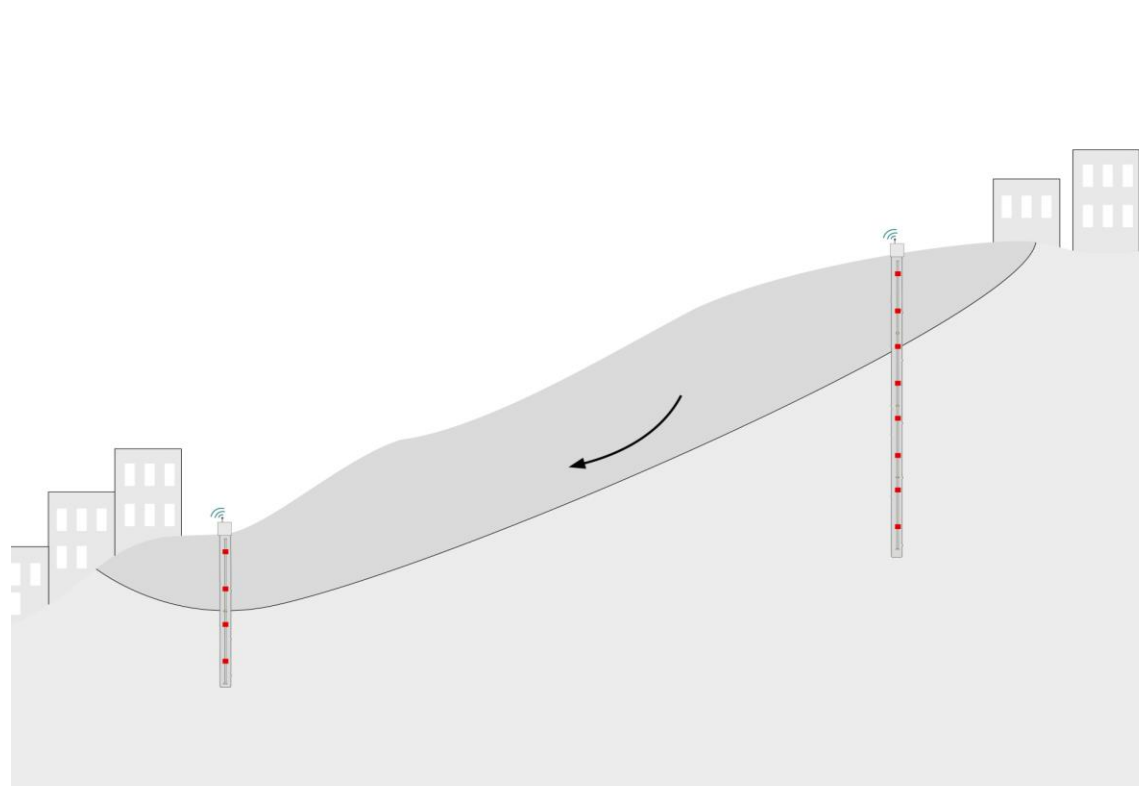

Application:

- *In this application LT-Inclibus measures a chain of local tilting, helping to detect any possible horizontal displacement.*
- *Initial sensors orientation and Azimuth are granted.*
- *LT-Inclibus is not intended to read cumulative displacement.*

Installation:

- *Lowered and fully grouted in boreholes or pipes/casings.*

__ APPLICATION SCHEME: RETAINING WALLS

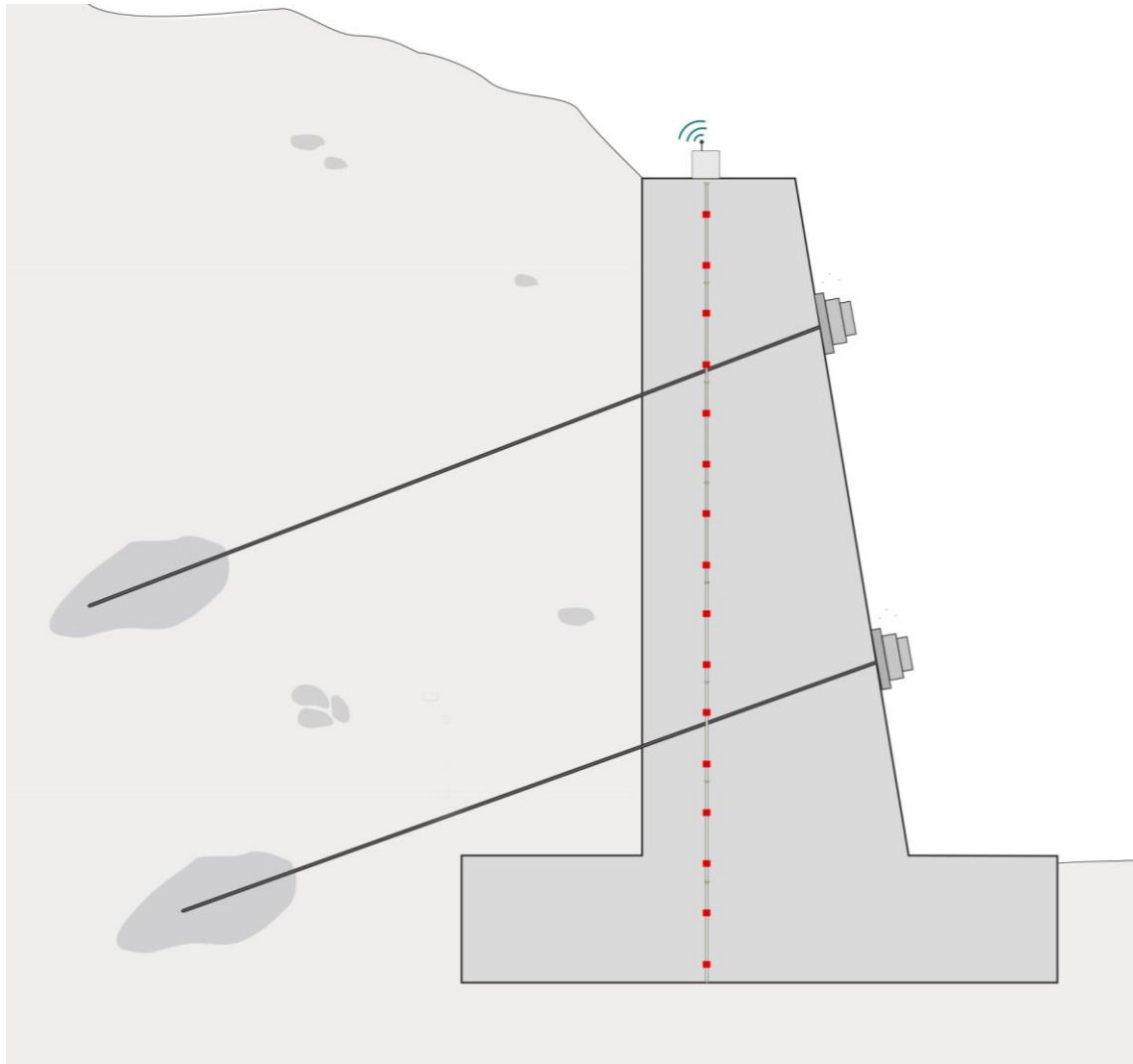

Application:

- *In this application LT-Inclibus measures a chain of local tilting, helping to detect any possible horizontal displacement.*
- *LT-Inclibus is not intended to read cumulative displacement*

Installation:

- *Grouted into reinforced concrete structure.*

APPLICATION SCHEME: LNG TANKS

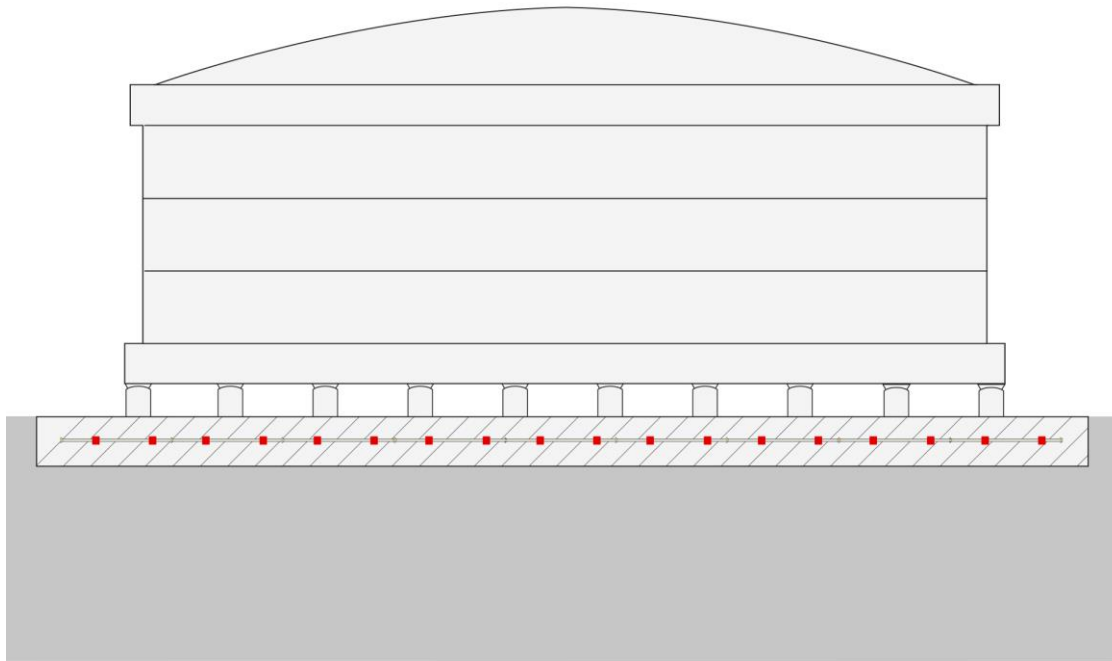

Application:

- *In this application LT-Inclibus measures a chain of local tilting, helping to detect any possible vertical displacement.*
- *LT-Inclibus is not intended to read cumulative displacement*

Installation:

- *Grouted within foundations.*
- *Inserted and grouted within horizontal casings/pipes.*

APPLICATION SCHEME: SETTLEMENTS CAUSED BY TUNNELING/EXCAVATION

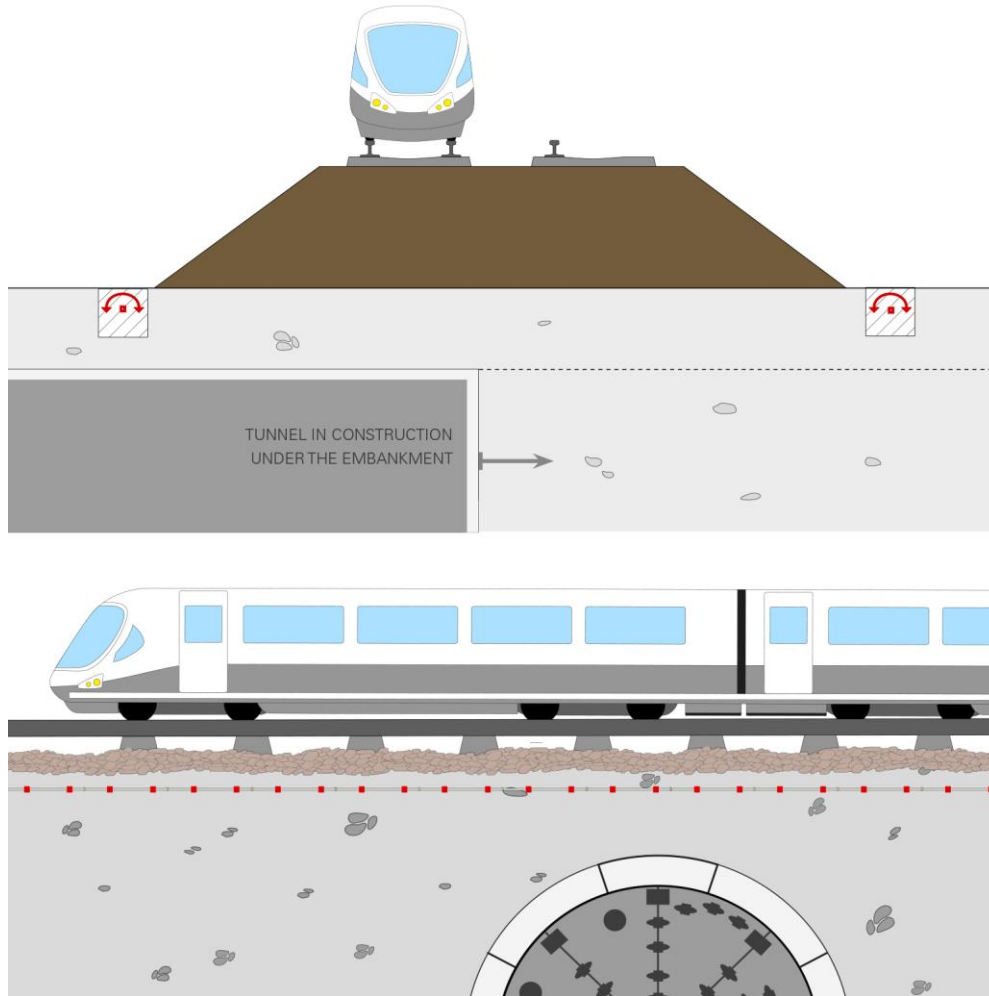

Application:

- *In this application LT-Inclibus measures a chain of local tilting, helping to detect any possible local settlement or movement.*
- *LT-Inclibus is not intended to read cumulative displacement*

Installation:

- *Layed in tranches and backfilled.*

__ APPLICATION SCHEME: TAILING DAM SLOPE STABILITY

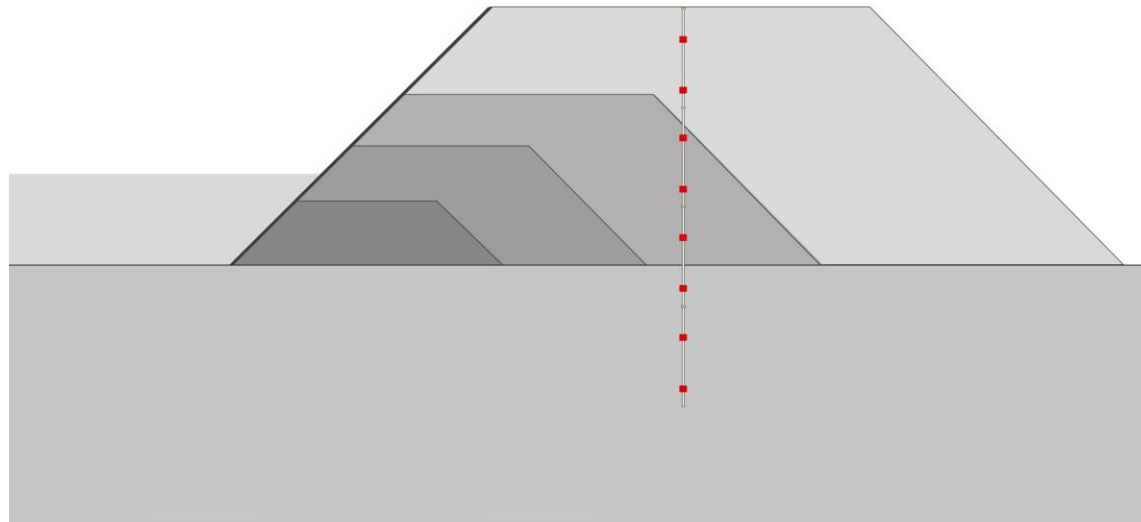

Application:

- *In this application LT-Inclibus measures a chain of local tilting, helping to detect any possible horizontal displacement.*
- *LT-Inclibus is not intended to read cumulative displacement*

Installation:

- *Lowered and fully grouted in boreholes or casings/pipes.*

__ APPLICATION SCHEME: BRIDGE DECKS DEFORMATION

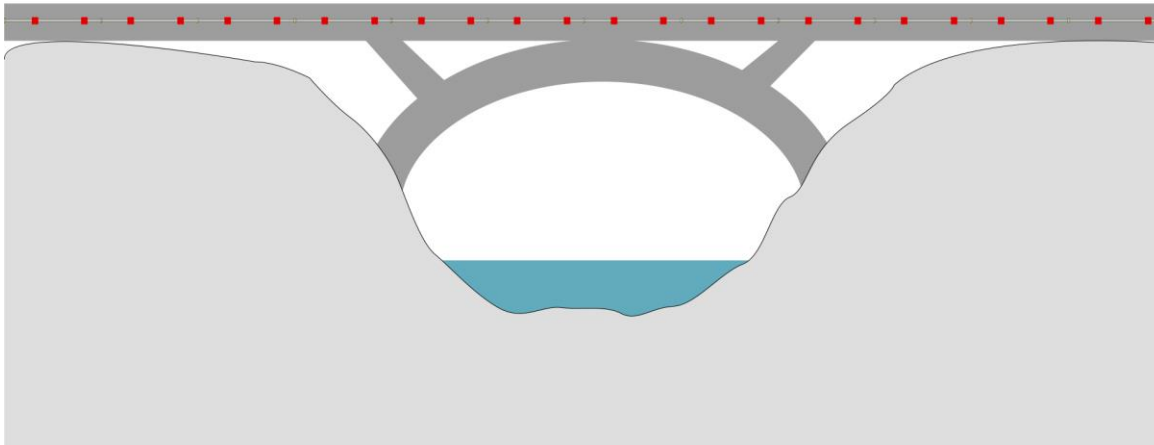

Application:

- *In this application LT-Inclibus measures a chain of local tilting, helping to detect any possible vertical displacement.*
- *LT-Inclibus is not intended to read cumulative displacement*

Installation:

- *Grouted into deck reinforced concrete structure.*

__ APPLICATION SCHEME: VIADUCT STRUCTURAL DEFORMATION

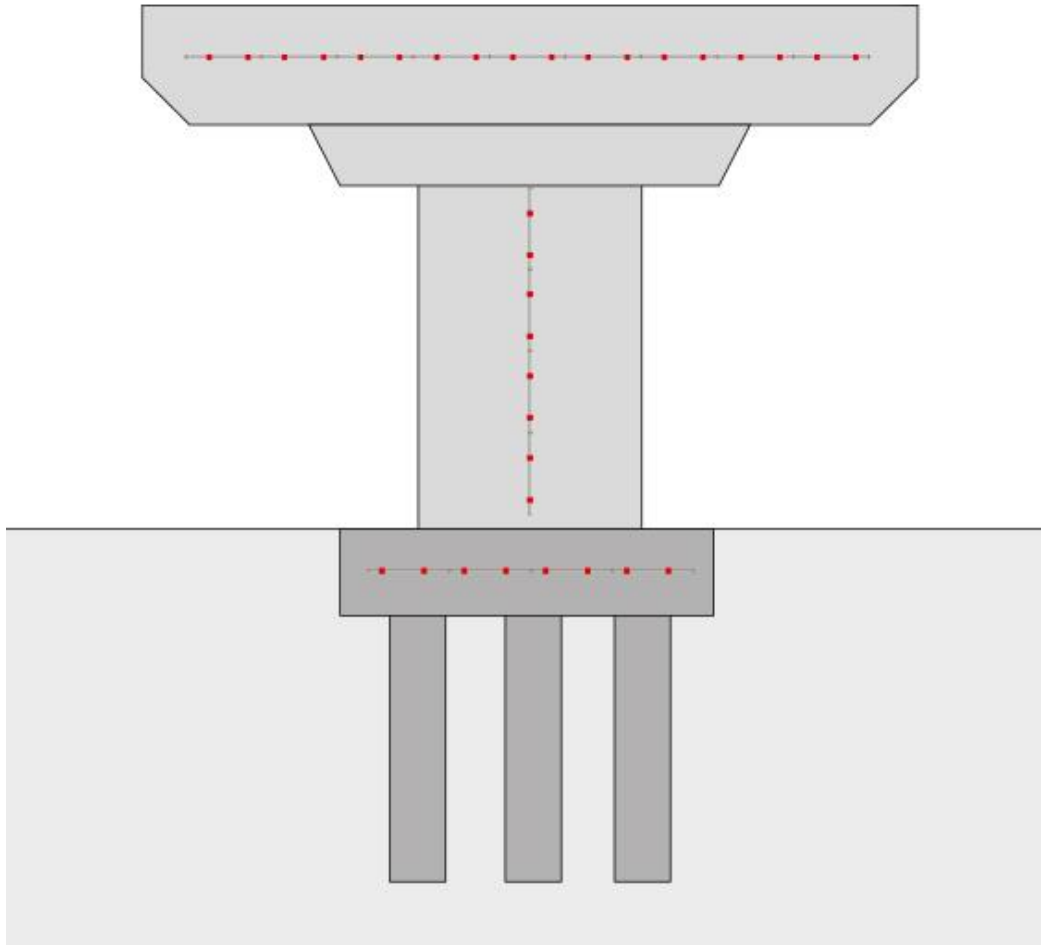

Application:

- *In this application LT-Inclibus measures a chain of local tilting, helping to detect any possible vertical and/or horizontal displacement.*
- *LT-Inclibus is not intended to read cumulative displacement*

Installation:

- *Grouted into deck/pile reinforced concrete structure.*



SISGEO S.R.L.

VIA F. SERPERO 4/F1
20060 MASATE (MI) ITALY
PHONE +39 02 95764130

INFO@SISGEO.COM

WWW.SISGEO.COM

All the information in this document is the property of Sisgeo S.r.l. and should not be used without permission from Sisgeo S.r.l. We reserve the right to change our products without prior notice. The datasheet is issued in English and other languages. In order to avoid discrepancies and disagreement on the interpretation of the meanings, Sisgeo Srl declares that English Language prevails.